

FIRE LANE REQUIREMENTS

TO ASSIST IN THE PREPARATION AND SUBMITTAL OF REQUIRED DETAILS FOR FIRE LANES ON PLANS, THE FOLLOWING MINIMUM INFORMATION SHALL BE PROVIDED: VEHICULAR TRAVEL WAY AREAS LOCATED ON PRIVATE PROPERTY WHERE PARKING OR OTHER OBSTRUCTIONS HAVE BEEN PROHIBITED FOR LIFE SAFETY REASONS, A MEANS OF PROVIDING CONTINUAL EMERGENCY VEHICLE ACCESS FOR MULTI-FAMILY, COMMERCIAL AND INDUSTRIAL DEVELOPMENTS SHALL COMPLY WITH THE FOLLOWING DETAILS. ADDITIONAL INFORMATION MAY BE REQUIRED ON A CASE-BY-CASE BASIS AS DETERMINED BY THE PLAN REVIEWER.

DESIGNATION OF TYPE AND PLACEMENT:

A. TYPE OF FIRE LANE AND SPECIFIC LOCATIONS NECESSARY ARE AT THE DISCRETION OF THE RIVERSIDE COUNTY FIRE DEPARTMENT.

B. DETERMINATION WILL BE BASED ON PROJECT SITE CONFIGURATION AND THOSE ACCEPTED STANDARDS IDENTIFIED BELOW.

CONFIGURATION AND MARKING:

A. ON STREETS, DRIVEWAYS, ETC., WHERE CURBS ARE INSTALLED, CURBS SHALL BE PAINTED RED AND EVERY THIRTY (30) FEET THERE SHALL BE WHITE LETTERS SPELLING OUT "NO PARKING - FIRE LANE - CVC 22500.1". ALL LETTERS AND NUMBERS SHALL BE A MINIMUM OF THREE (3) INCHES (SEE FIGURE 1).

B. ON STREETS, DRIVEWAYS, ETC., WHERE NO CURBS EXIST, PAINT TWO (2) PARALLEL WHITE LINES APPROXIMATELY SIX (6) INCHES APART ALONG THE EDGE OF THE ROADWAY AND PAINT THE LINE BETWEEN THE WHITE LINES RED. EVERY THIRTY (30) FEET ALONG THE RED LINE, WHITE LETTERS SHALL BE PAINTED WITH "NO PARKING - FIRE LANE - CVC 22500.1" (SEE FIGURE 2).

C. ON STREETS, DRIVEWAYS, ETC., WHERE NO CURB EXISTS AND THE ENTIRE RIGHT-OF-WAY IS TO BE A FIRE LANE, PAINT BOTH SIDES OF THE STREET AS INDICATED IN SECTION B ABOVE. PAINT WHITE LETTERS IN THE STREET FIVE (5) FEET IN HEIGHT "FIRE LANE - NO PARKING - FIRE LANE - CVC 22500.1". VERTICAL SEPARATION BETWEEN WORDS SHALL BE FORTY (40) FEET (SEE FIGURES 2 & 3).

D. ON PROJECTS WHERE SPECIAL SITUATIONS EXIST (I.E., PARKING LOTS WITHOUT CURBS, ETC.) AND A FIRE LANE OF A PARTICULAR WIDTH IS DESIRED, THE FOLLOWING MAY APPLY (SEE FIGURE 4).

E. ON STREETS OR DRIVEWAYS WHERE AN ALTERNATE METHOD IS DESIRED (SEE FIGURE 5).

F. TEMPORARY OR PERMANENT "POSTING" WITH SIGNS IS PERMITTED WITH POSITIONING OF SIGNS DESIGNATED BY THE FIRE DEPARTMENT. STANDARD "NO PARKING" SIGN SIZE SHALL BE USED. SIGNS SHALL BE WHITE WITH RED LETTERING. "NO PARKING - FIRE LANE - CVC 22500.2". SIGNS SHALL BE SPACED 30 FEET APART (SEE FIGURE 6).

G. IN SPECIAL CIRCUMSTANCES WHEN NONE OF THE ABOVE STANDARDS ARE SATISFACTORY, THE FIRE DEPARTMENT MAY DESIGNATE MARKINGS OR SIGNS OF A SPECIAL TYPE BASED ON THE INDIVIDUAL CIRCUMSTANCES.

LEGEND

- FIRE LANE MARKING
- FIRE INGRESS ROUTE
- F.H. FIRE HYDRANT

* NOTE: ALL EXTERIOR WALL TO BE MINIMUM 2HR FIRE RATED. U.N.O.

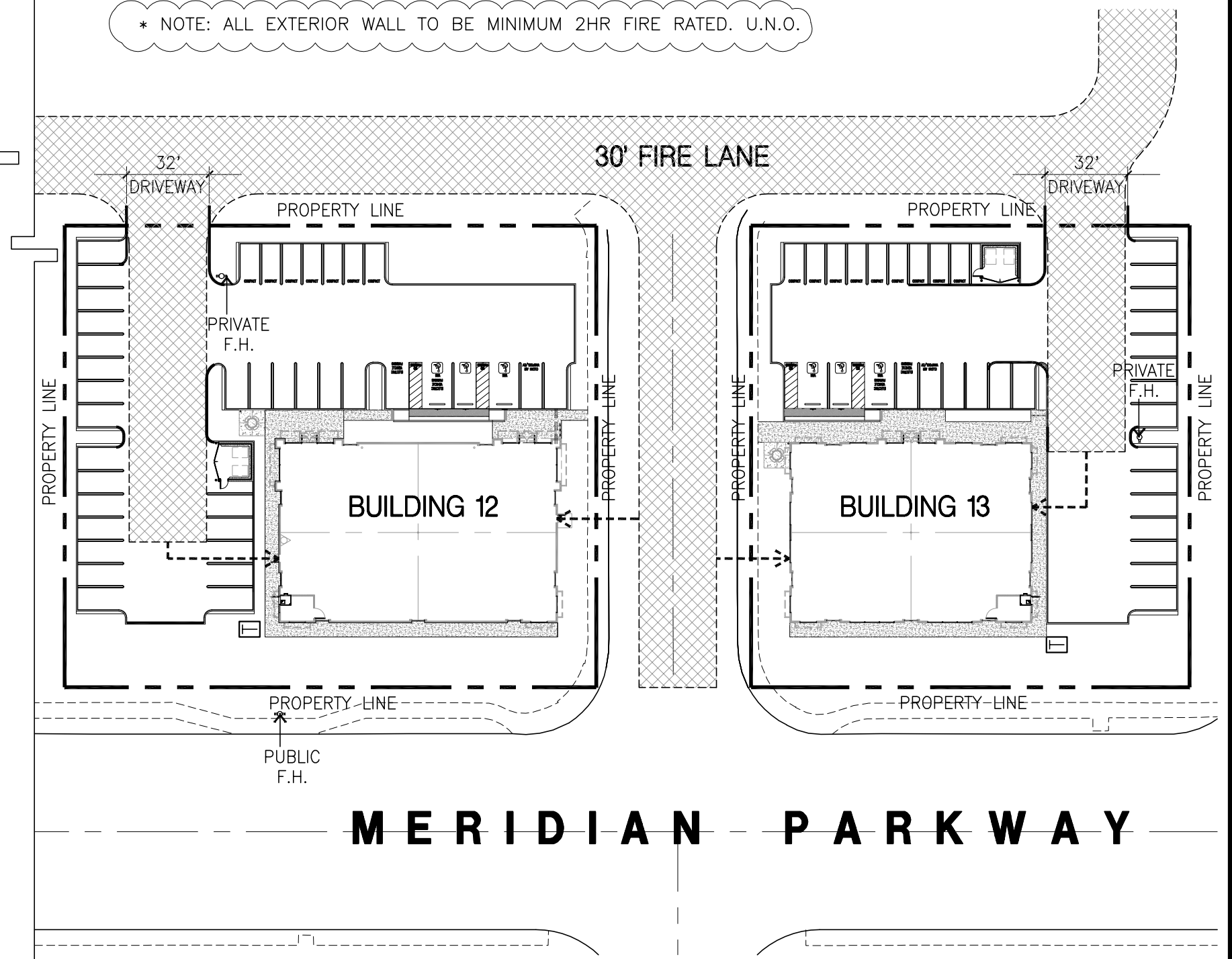

MASTER SITE PLAN

scale: 1"=50'-0"

SCALE: 1"=50'-0"

0 50' 100' 150' TRUE

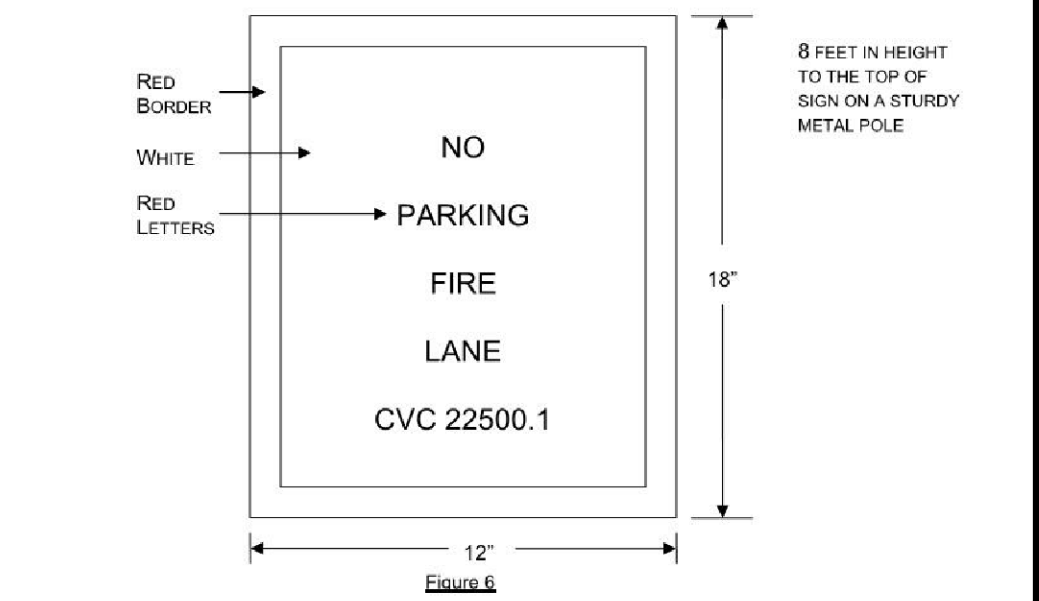
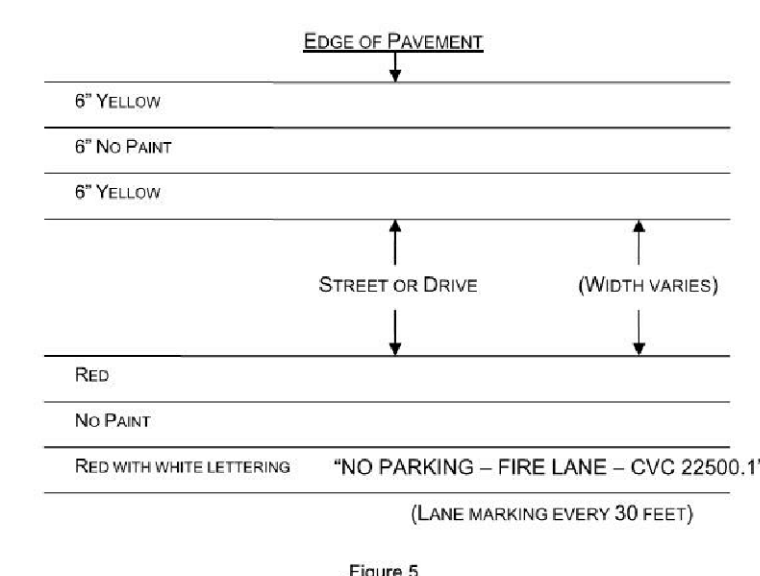
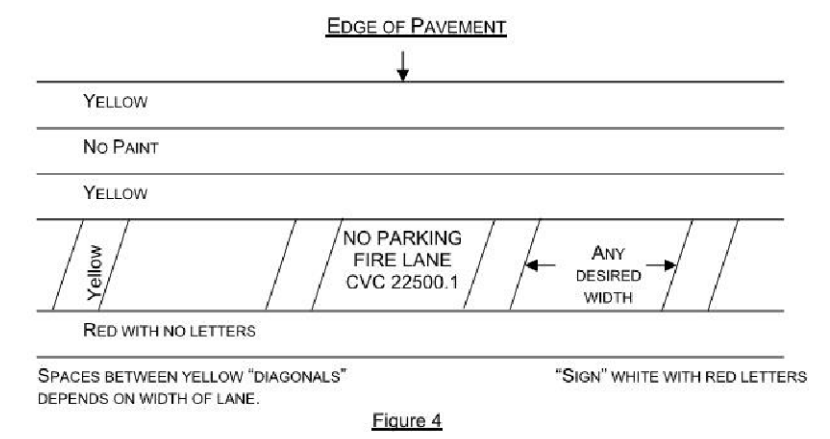
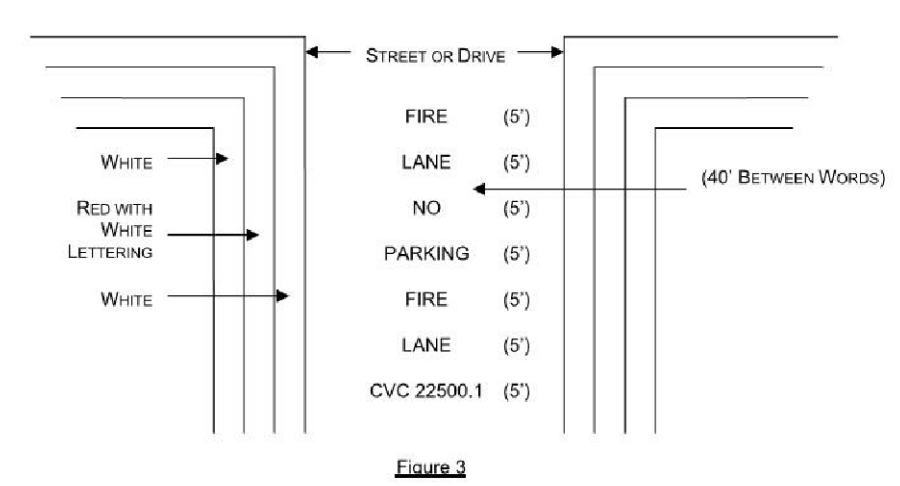
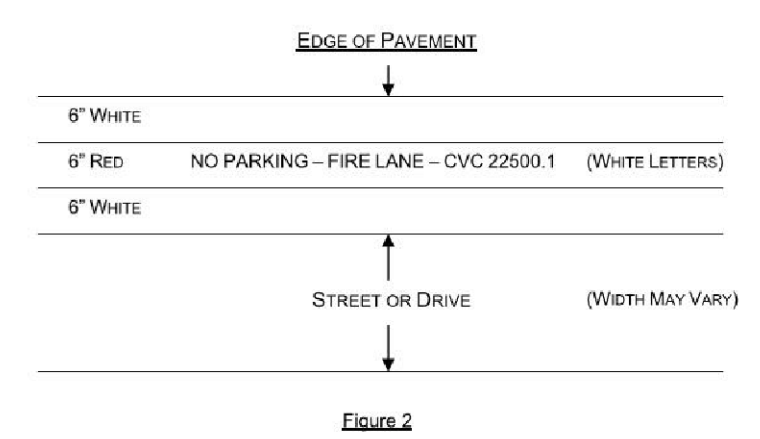
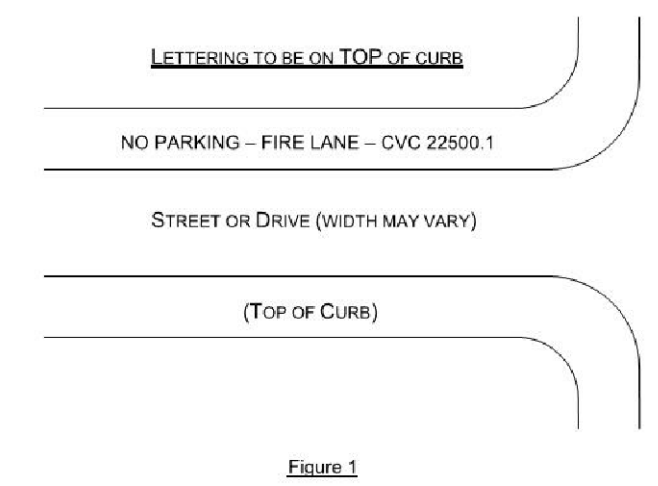

CAUTION : IF THIS SHEET IS NOT A 24" X 36" IT IS A REDUCED PRINT



hpa, inc.
18831 bardeen avenue, - ste. #100
irvine, ca
92612
tel: 949-863-1770
fax: 949-863-0851
email: hpa@hparchs.com



Owner:
MS ALESSANDRO LLC
C/O

101 HODENCAMP ROAD, STE 200
THOUSAND OAKS, CA 90703
TEL: (805) 494-1226

Project:
MS
ALESSANDRO

Riverside, CA

Consultants:

Civil: SDH INC.
Structural: HSA & ASSOCIATES INC.
Mechanical: BLAKE
Plumbing: JOHNSON PLUMBING
Electrical: VAL ELECTRICAL
Landscape: HUNTER LANDSCAPE
Fire Protection: GUPF
Soils Engineer: NORCAL

Title: master site plan

Project Number: 16490
Drawn by: ZR
Date: 06/16/17

Revision:

PLAN CHECK CORR. 8/11/17
BIDSET 8/31/17
PLAN CHECK CORR. 10/11/17
ASI#1 12/07/17

Sheet:

A1.0F